



Artist's impression. Neighbouring houses not shown



2



1



2



2

Designed for those who love to entertain

The Moonflower offers a fresh and functional open plan design with a spacious kitchen overlooking the dining and living areas with sliding doors onto the outdoor alfresco – the perfect spot to entertain! Enjoy an oversized master with a walk-in robe and ensuite, host family in the guest bedroom with separate bathroom, and utilise the flexibility of a multi-purpose room.

- Modern kitchen with walk-in pantry
- Master with WIR and ensuite
- Guest bedroom and multi-purpose room
- Outdoor covered alfresco
- Double garage

Artist's render - Clubhouse



Artist's render - Pool



Moonflower

- 1 Living
- 2 Dining
- 3 Kitchen
- 4 Bedroom 1
- 5 Ensuite
- 6 Bedroom 2
- 7 Bathroom
- 8 Alfresco
- 9 Double Garage
- 10 Multi-Purpose Room
- 11 Laundry
- 12 Walk-In Robe
- 13 Walk-In Pantry

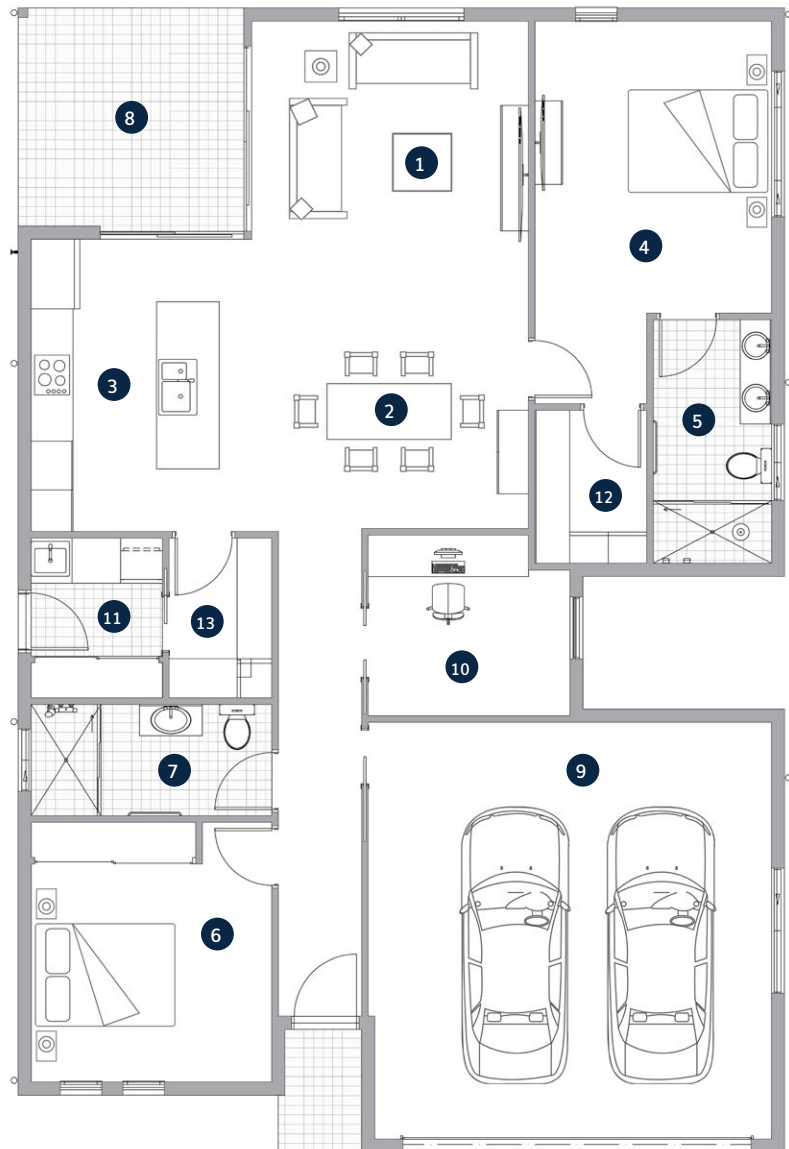

Living	3.9m x 3.6m
Dining	3.9m x 3.6m
Kitchen	2.7m x 4.2m
Bedroom 1	3.4m x 4.2m
Ensuite	1.7m x 3.5m
Walk-In Robe	1.6m x 2.2m

Bedroom 2	3.5m x 3.1m
Bathroom	3.5m x 1.6m
Alfresco	3.2m x 3.1m
Double Garage	6.0m x 5.8m
Multi-Purpose Room	2.1m x 2.9m
Total Area	180.7m²



*The facade renders and floorplans are provided for illustrative purposes only. It may contain upgraded items/finishes not included as standard. For detailed home pricing, please talk to a sales consultant. All efforts have been made to ensure accuracy of this brochure at time of print.

A new way of living.

HOMETOWN AUSTRALIA
COMMUNITIES